

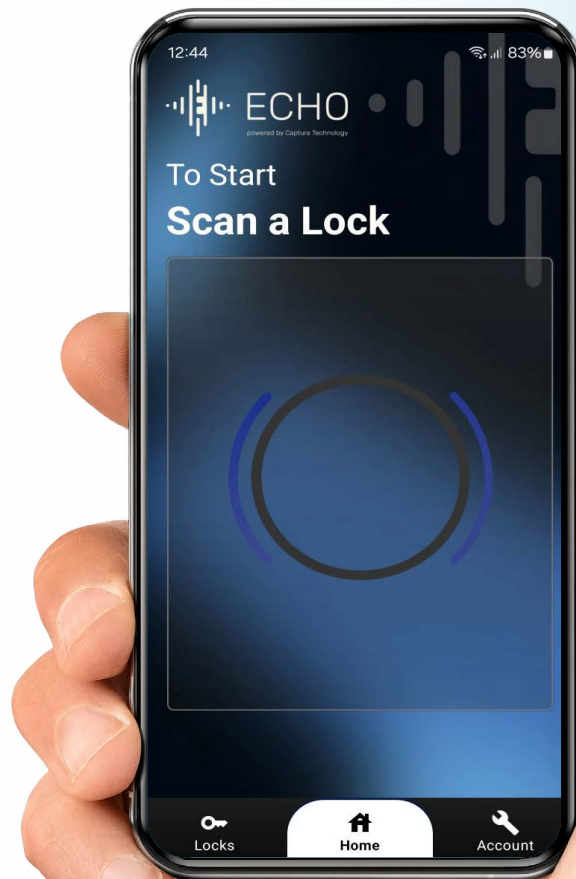

# ECHO App End User Guide

This guide will show you, the end user, how to navigate the use of the ECHO Lock App including how to open and close the lock.



# Contents

## Page 3

Introduction

Pre-requisites

Requirements

Navigating the App Store

## Page 4

ECHO User Steps

Step 1: Open the ECHO App

Step 2: Creating an account

Step 3: Entering your email

Step 4: Entering a password

## Page 5

Step 5: Verifying your account

Step 6: Logging into the App

Step 7: Locking your ECHO lock

Step 8: Lock allocated to a user

## Page 6

Step 9: Unlocking your ECHO lock

Step 10: Sharing your ECHO lock

## Page 7

Step 11: Unlocking and removing your locker allocation

# Introduction

The ECHO smart lock application turns your smartphone into a key for your ECHO smart lock, using NFC (Near Field Communication) technology. No more keys or combinations—just a tap to access your locker.

This guide will walk you through setup and usage, making it easy to start enjoying secure, battery free, smart access.

Let's get started!

## Pre-requisites

### Requirements

- ✓ A mobile device with NFC capabilities.
- ✓ Mobile network connection or WiFi connection
- ✓ An ECHO smart lock.
- ✓ The “ECHO” app installed on your device.

### Navigating the App Store

1. Navigate to the Apple/Google App Store and search for the “ECHO” app.
2. Once you've found the app, press the download button to install it.



**Android App**  
Scan to download



**Apple App**  
Scan to download

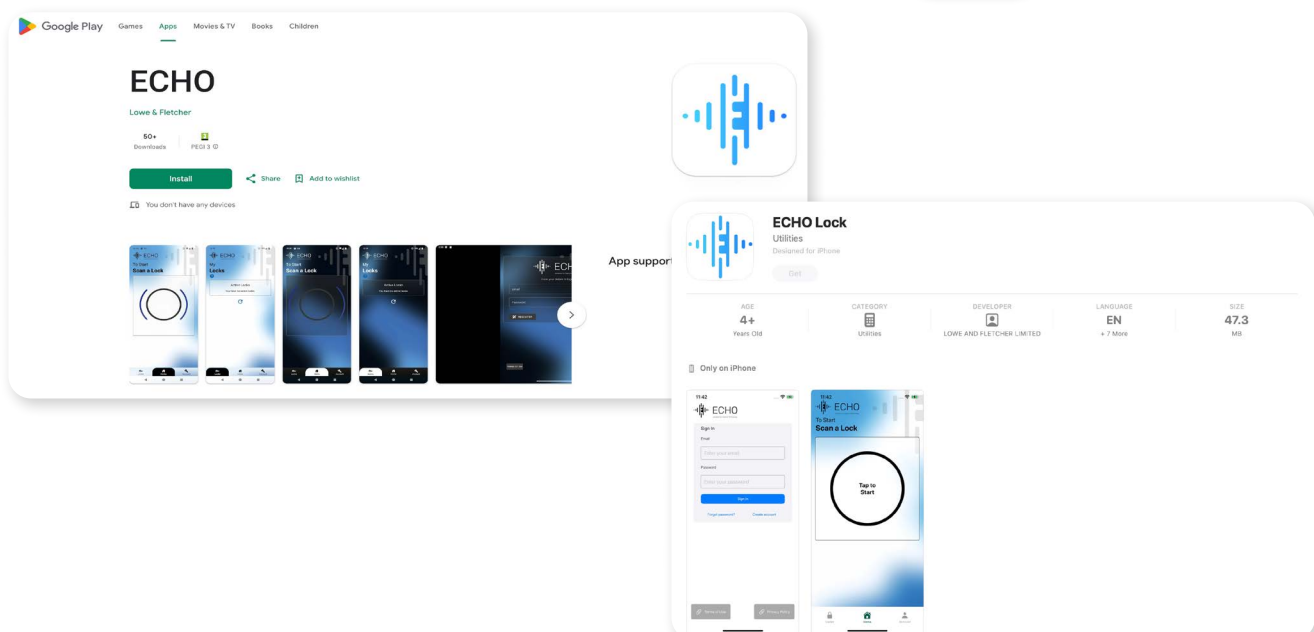

# ECHO User Steps

## Step 1: Open the “ECHO” app

On your mobile device, navigate to the ECHO Application that you downloaded in the “Pre-Requisite” section.

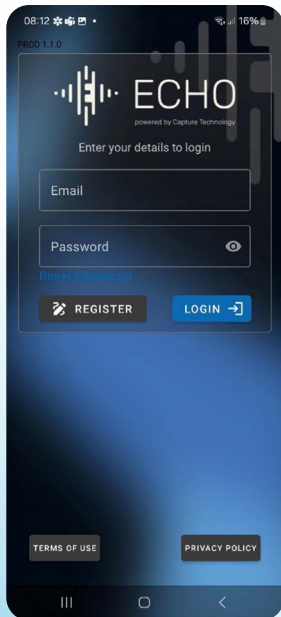

## Step 2: Creating an account

Once the app is open, you will see the login page. Tap the Register button to start creating your account.

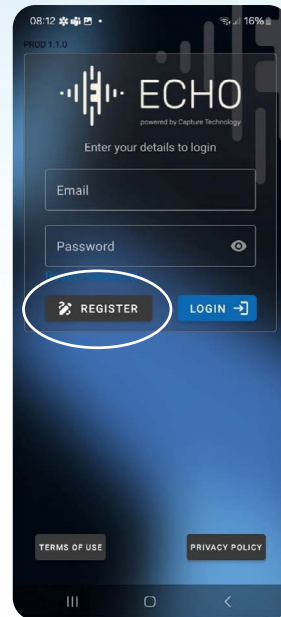

## Step 3: Entering your email

After tapping Register, you'll be prompted to enter your email address. Please ensure a valid and correctly typed email address is entered, as a verification code will be sent to this address.

You should next read both the Terms of Use and Privacy Policy documents associated with the ECHO smart application. Tick the box to accept the Terms of Use and Privacy Policy in order to be able to tap Register again once all information is entered.

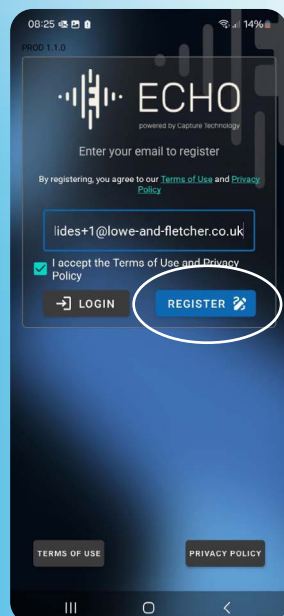

## Step 4: Entering a password

You'll now be asked to create a password. Enter the same password in both the Password and Confirm Password fields, then proceed.

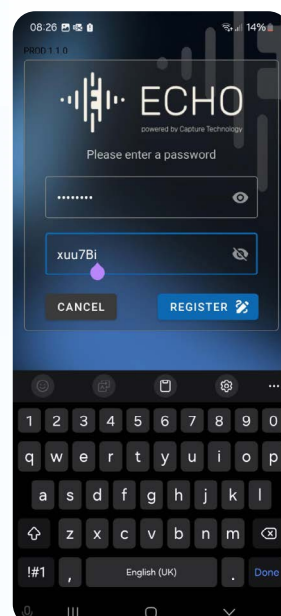

## Step 5: Verifying your account

At the Verification page, you are required to enter the verification code which will have been sent to the e-mail address previously entered. Check your email inbox, enter the code in the Verification Code field, and press the Verify button.

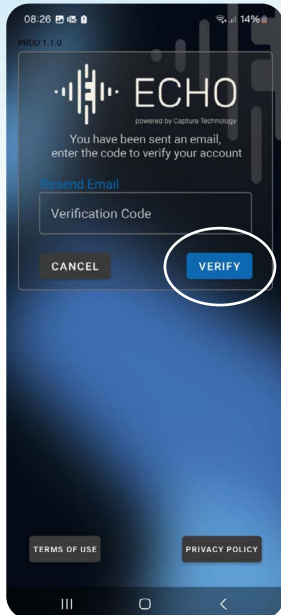

## Step 6: Logging into the app

Once your account is verified, you may log in using the email and password you just created. After pressing Login, you should enter your First and Last Name and tap continue.

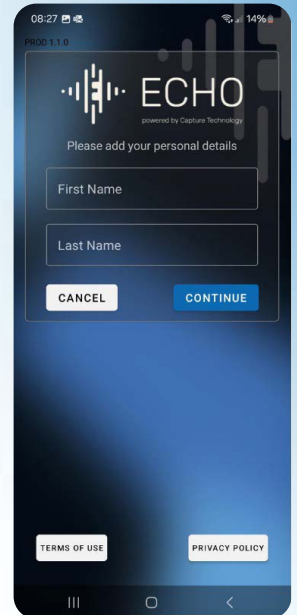
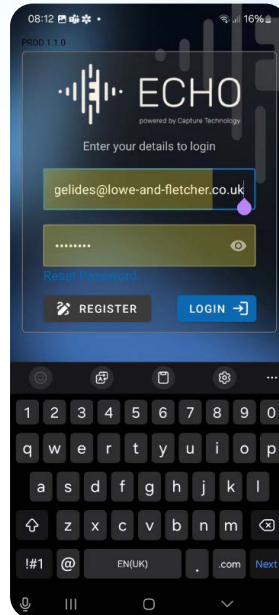

## Step 7: Locking your ECHO lock.

To lock your ECHO lock, make sure you have closed the door and turned the ECHO lock into the closed position so that the door cannot be opened. Next, press the Home tab at the bottom of the page.

- ✓ For Apple devices, touch the screen and then hold your mobile device against the ECHO lock.
- ✓ For Android devices, hold your device against the lock, move your device away from the lock when prompted to do so, then hold it against the lock again to as instructed.





## Step 8: Lock allocated to a User

After locking your ECHO lock, a completion screen will appear. You can view your active locks by tapping the Locks tab in the bottom left corner, this will list all locks in use by that User. Press the (?) button for an explanation of the Symbols used to indicate the status of the lock.

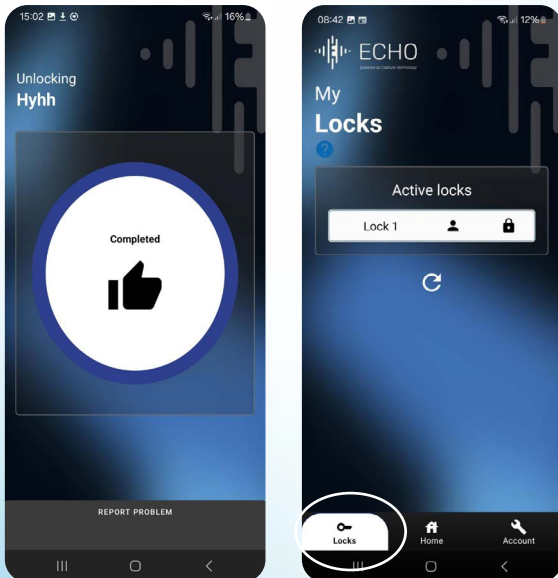

## Step 9: Unlocking your ECHO lock

To unlock your ECHO lock, press the Home tab.

- ☑ For Apple devices, touch the screen and then hold your mobile device against the ECHO lock.
- ☑ For Android devices, hold your device against the lock, move your device away from the lock when prompted to do so, then hold it against it the lock again to as instructed.



## Step 10: Sharing your ECHO lock

Should you wish to share access to your ECHO lock with another user, you can do so by pressing the locks tab and then the blue square button next to the active lock you wish to share access with. Next, add the correct e-mail address of the user you wish to share access with and press the blue square button. A message will be shown "Guest will be added" when complete.

To remove shared access, select the lock from the Locks Tab by pressing the blue square button and then delete the user from the list by pressing the bin button. "Guest has been removed" when this has been completed successfully.

**Note 1:** Only locks in Private mode may be shared with other users.

**Note 2:** The user given shared access must first have the ECHO mobile application downloaded onto their mobile device and a valid user must be registered in the ECHO mobile application.

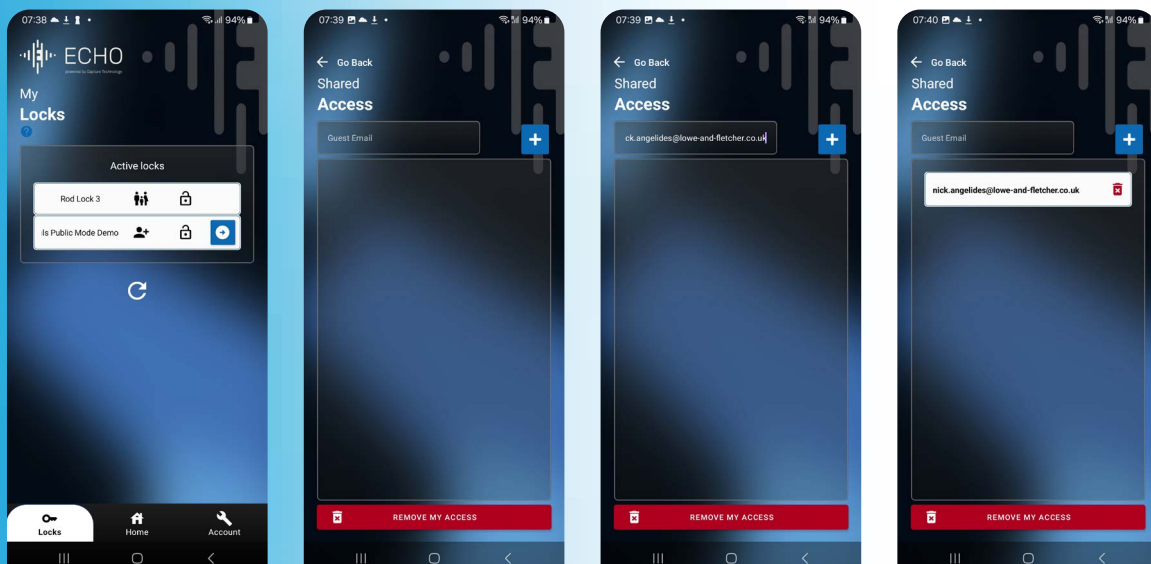

# Need help? We're all ears!



**ECHO Lowe & Fletcher**  
[echolock.lowe-and-fletcher.co.uk](mailto:echolock.lowe-and-fletcher.co.uk)



**ECHO Lowe & Fletcher Inc**  
[echolock.loweandfletcherinc.com](mailto:echolock.loweandfletcherinc.com)



**ECHO Euro-Locks**  
[echolock.euro-locks.com](mailto:echolock.euro-locks.com)

## **Lowe & Fletcher Ltd (UK)**

E: [sales@lowe-and-fletcher.co.uk](mailto:sales@lowe-and-fletcher.co.uk)  
T: +44 (0) 121 505 0400

## **Lowe & Fletcher Inc (USA)**

E: [sales@loweandfletcherinc.com](mailto:sales@loweandfletcherinc.com)  
T: +1 (616) 994 0490

## **Euro-Locks SA NV (Belgium)**

E: [sales@euro-locks.be](mailto:sales@euro-locks.be)  
T: +32 61 212.261

## **Euro-Locks SA (France)**

E: [euro-locks@euro-locks.fr](mailto:euro-locks@euro-locks.fr)  
T: +33 (0)3.87.92.61.11

## **Euro-Locks Sicherheitseinrichtungen GmbH (Germany)**

E: [vertrieb@euro-locks.de](mailto:vertrieb@euro-locks.de)  
T: +49 (0) 6897 9072 0

## **Euro-Locks Sp. z o. o. (Poland)**

E: [sekretariat@euro-locks.pl](mailto:sekretariat@euro-locks.pl)  
T: +48 (32) 344-78-70, -82, -84

